

建築プロジェクト資料コレクション Building Types Online

In cooperation with Bauwelt

【価格体系】:

「買切型」と「年間購読型」の二種類があります。

同時アクセス数 無制限

◆買切型: お問合せ下さい

◆年間アップデート料金: お問合せ下さい*

*アップデートをご希望されない場合は、
買切型価格のみでも購入可能です。

◆年間購読型: お問合せ下さい

※6年間連続購読すると、買切となります。

言語: 英語

Editor-in-Chief: Oliver Heckmann, Urban Housing Lab, Berlin

Editors for Birkhäuser: Ria Stein, Andreas Müller (until 2021)

Associate Editor: Eric Zapel

Assistant Editor Images: Dmytro Churikov

Manager Publishing Technology and Applications: Bettina de Keijzer

建築設計の研究と実践のためのデータベース。建築分野において国際的に名高い出版社 Birkhäuser の専門書、建築の専門家や編集者の知識、優れた検索・閲覧機能、ダウンロード可能な図面・図版などが見事に融合しています。建築の研究者、実務家、専門機関・図書館、学生にお薦めします。

Birkhäuser: 建築、ランドスケープアーキテクチャー、デザインを専門とするスイスの出版社。建築家、インテリアデザイナー、都市プランナー、グラフィックアーティスト、プロダクトデザイナーなどを読者層に持ち、その専門性、書籍のデザイン性が高く評価されている。

《裏面に続きます》

G.C. 19360 リリース年=2016年 Annually Update

ご契約の際は、所属機関の IP アドレスが必要です。 FTE は問いません。同時ユーザー数は無制限です。

- 消費税に関しましては税制の改正に則った内容で対応させていただきます。掲載製品はリバースチャージ対象製品です。
- 原価の改定、為替相場の変動などの理由による価格の変更や掲載タイトルの変更につきましては、予めご了承の程お願い申し上げます。
- お見積もりは、別途ご用命ください。

(Walter de Gruyter / 日本総代理店 丸善雄松堂)

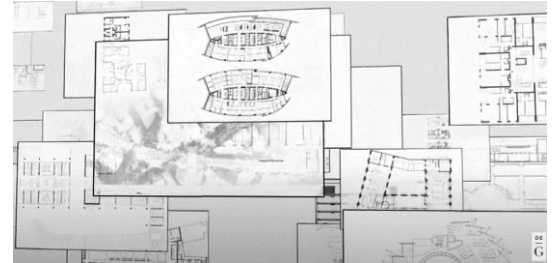

Building Types Online

トップ画面 →

Birkhäuser の専門書、ドイツを代表する建築専門誌 Bauwelt などから、論文・記事、プロジェクトを精選し、本データベースに収録しています。

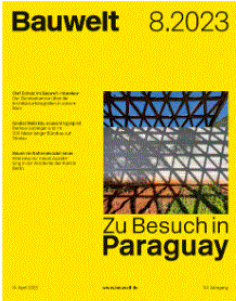

1,200 以上のプロジェクトを
種類別に検索可能
Building Types
Morphological Types
Urban Context
Thematic Articles

プロジェクトの例 ↓

各資料には、詳細な索引が付されています。

Akershus University Hospital

Cor Wagenaar, Noor Mens

In 2009, the design for Akershus University Hospital won C. F. Møller Architects the prestigious Building Better Healthcare Award. This prize-winning building is inspired by several of the innovative ambitions that began to pervade healthcare architecture in the 1990s: the wish to offer patients and staff a non-institutional, informal environment, the focus on patients rather than on medical processes and the awareness that the patients' experiences while staying in a hospital should not isolate them from everyday life outside. The architects decided against the use of design strategies that would hide the impressive size of this building. Instead, they borrowed a theme from urbanism and opted for a configuration of volumes connected via a five-story high, glass-covered central spine leading from the entrance, which faces south, to the children's ward that terminates the main axis in the north.

Most of the beds are accommodated in four 'fingers' that stretch out from the spinal cord. The patient wards have single and double bedrooms alternated with social spaces (squares) at every five rooms. Nurse stations are at the center of each ward. They have a balcony that provides them with natural daylight. All rooms have views on the park, the forest, and the mountains in the distance. To allow children to enjoy direct contact with the outside world as well, extra windows have been made beneath and also above the regular ones. Flatscreens with internet access have an integrated control panel that gives patients the possibility to adjust temperature and lighting. Since all outpatient departments are located on the central spine at the ground floor, the traffic their visitors usually produce is kept out of the rest of the building and concentrated in the main interior circulation artery, where it produces an almost urban atmosphere. Niches along the central street have been designed to act as waiting spaces. This arrangement implied the need to move the emergency department to the first floor. The hot floor has been arranged around four courtyards on the other side of the central artery. Teaching facilities are dispersed throughout the entire building, thus enhancing the interaction between students and hospital, and preventing separating the students from the medical working environment.

Building Type	Hospitals
Morphological Type	Complex/Ensemble
Urban Context	Campus, Green Spaces/Parks
Architect	C. F. Møller Architects
Year	2014
Location	Oslo
Country	Norway
Geometric Organization	Linear
Floor Area	118,000 m ²
Capacity	565 beds
Height	Mid-Rise (4 to 7 levels)

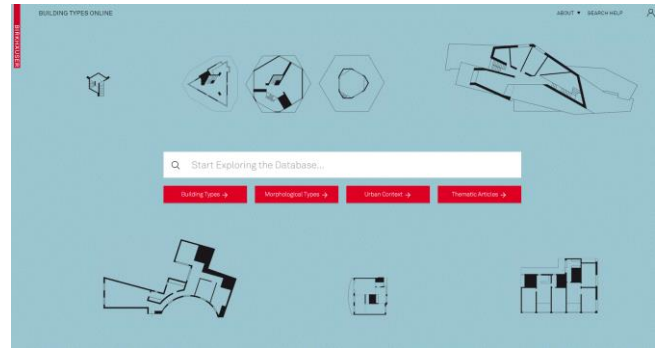
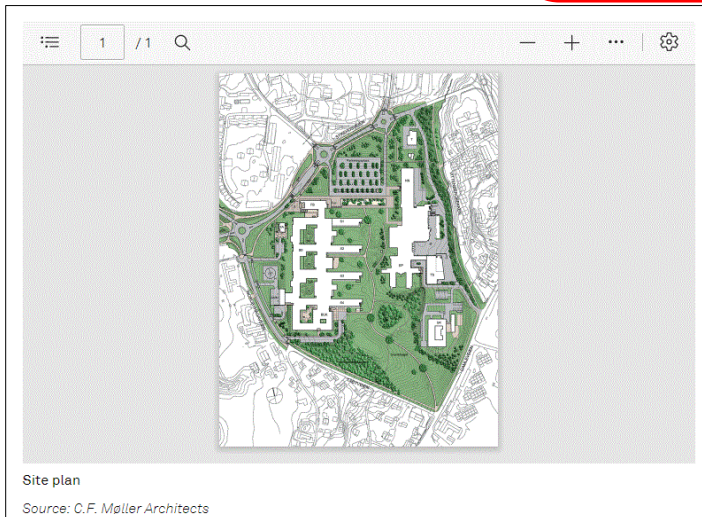

Building Types

Educational Buildings
158 projects

Hospitals
54 projects

Housing
644 projects

Industrial Buildings
53 projects

[See all projects →](#)

Morphological Types

Block Infill/Block Edge
226 projects

Clustered Low-Rise/Mat
133 projects

Complex/Ensemble
455 projects

Detached Building
172 projects

[See all projects →](#)

Urban Context

Campus
132 projects

Central Business District...
64 projects

Green Spaces/Parks
40 projects

Industrial Area/Business ...
152 projects

[See all projects →](#)

Thematic Articles

LIBRARIES
The Library in its Social Context
by Liliana Wong, Nelson Lusignea

HOUSING
Inhabiting Paths: On Ladders, Stairs and Galleries
by Monica Kuschnir, Lucia Velazquez

OFFICE BUILDINGS
Office Work in Global Networks
by Wilhelm Bauer, Peter Klein

HOUSING
Land Use and Land Prices
by Laura Wälchli

[See all articles →](#)

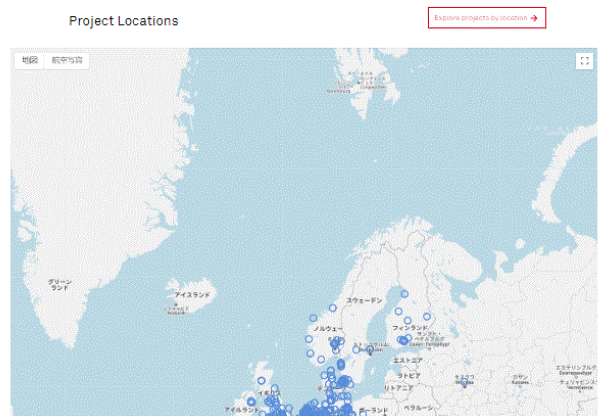

無料トライアル 受付中

